

Greenway, Totteridge, N20 8EL
£2,000,000 Freehold Council Tax Band G

REAL ESTATES
Est.1981

Estate Agents · Residential Sales · Investments · Lettings

Sold Off-Market – This outstanding five-bedroom detached residence has been successfully sold off-market in one of Totteridge’s most prestigious locations.

Due to continued high demand, we are urgently seeking similar properties for qualified buyers.

Greenway, London, N20

Approximate Area = 2014 sq ft / 187.1 sq m

Garage = 146 sq ft / 13.5 sq m

Outbuilding = 41 sq ft / 3.8 sq m

Total = 2201 sq ft / 204.4 sq m

For identification only - Not to scale

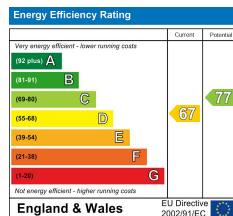
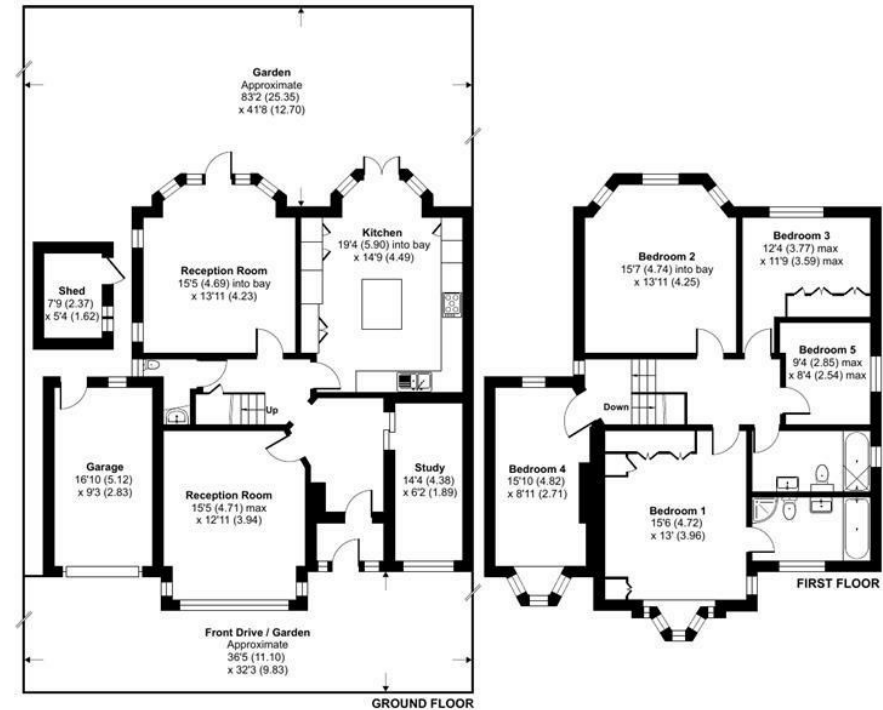

Floor plan produced in accordance with RICS Property Measurement 2nd Edition, Incorporating International Property Measurement Standards (IPMS2 Residential). © nñcheom 2026. Produced for Real Estates. REF: 1404190